

## 7 - Step Comprehensive Water Purification(Standard Carbon Filter)

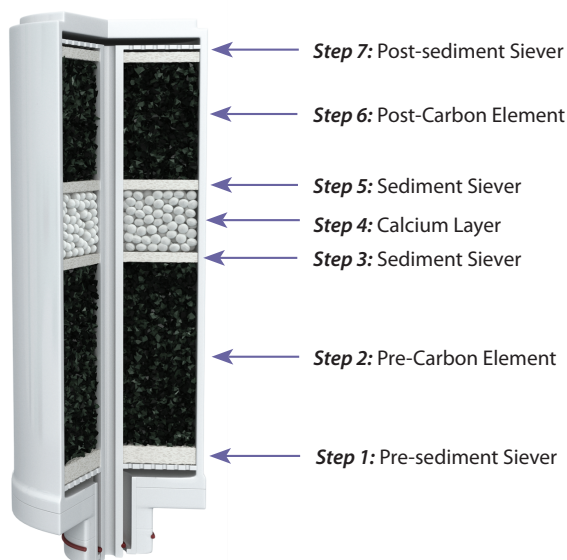

- **Sediment Siever**  
Filters the suspended substances, rust and sediments etc.
- **Pre-Carbon Element**  
Provides first round activated carbon filtering of impurities to improve colour and taste of water while removing odour. Impregnated with silver, it also doubles up as an anti-bacterial element to inhibit the growth of bacteria within the filter.
- **Calcium Layer**  
Adds calcium to increase the alkaline mineral content in water, thus facilitating the electrolysis process.
- **Post-Carbon Element**  
Removes any remaining agrichemicals, disinfectants, phenol, trihalomethane and other harmful chemicals in source water. Enhancing the anti-bacterial effects, the element is impregnated with silver for extra bacteria resistance.

## 8 - Step Ultra Water Purification(Advanced Ultra Hollow Membrane Filter)

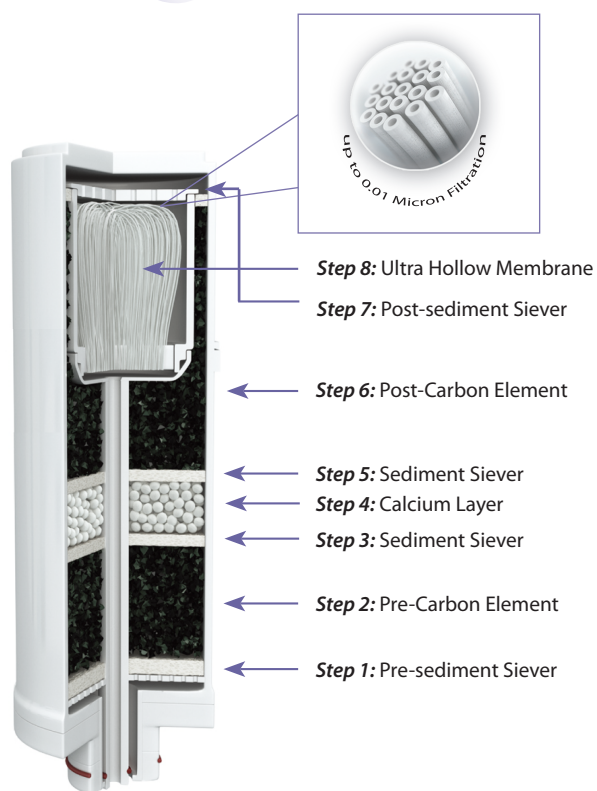

- **Sediment Siever**  
Filters the suspended substances, rust and sediments etc.
- **Pre-Carbon Element**  
Provides first round activated carbon filtering of impurities to improve colour and taste of water while removing odour. Impregnated with silver, it also doubles up as an anti-bacterial element to inhibit the growth of bacteria within the filter.
- **Calcium Layer**  
Adds calcium to increase the alkaline mineral content in water, thus facilitating the electrolysis process.
- **Post-Carbon Element**  
Removes any remaining agrichemicals, disinfectants, phenol, trihalomethane and other harmful chemicals in source water. Enhancing the anti-bacterial effects, the element is impregnated with silver for extra bacteria resistance.
- **Ultra Hollow Membrane**  
Traps and eliminates Bacteria, algae, fungi, micro-organisms(Protozoa, Giardia, cysts), rust, metal particles and lead. This ultra-fine filtration effectively removes pollutants and impurities up to particle size of 0.01 microns, while keeping the essential alkalising minerals intact.